



at&t

Quick start guide

TL7910

DECT 6.0 cordless headset



Introduction

The TL7910 is a cordless headset and base that allows you to have handsfree phone conversations. It can be used in different ways depending on your needs. Choose from the following three options. Connect your TL7910:

- **To a telephone line only** (page 8). Connect the headset to a telephone wall jack. Use the telephones on the same telephone line to make or answer calls. The headset is a supplementary device that can join the calls.
- **To a traditional corded telephone** (pages 9-10). Connect the headset to a corded telephone. If you also install a lifter (AT&T TL7100, purchased separately) on your corded telephone, you can use the headset to remotely control the lifter for answering or hanging up a call.
- **To both a PC and telephone line** (pages 11-13). Connect a phone line to the headset base and the USB cable to your PC. You can make and answer VoIP calls through Skype™ or Microsoft Lync®, or landline calls using the **AT&T Softphone Call Manager**. You can also use the voice command feature to call the desired number after you installed the **AT&T Softphone Call Manager**.

Install the **AT&T Softphone Call Manager** using the **CD-ROM** provided in the package. You may also visit **www.telephones.att.com/downloads** to download the software. Unzip and install the file after download.

For installation and operation instructions of the software, refer to the **Installation and Operation Guide** which can also be found in the **CD-ROM** provided or the web site stated above.

This quick start guide provides you with the basic installation and setup instructions.

You may refer to the user's manual provided in the product package for complete installation and operation instructions, or you can visit **www.telephones.att.com/manuals** to download the manual.

For customer service or product information, visit our website at **www.telephones.att.com** or call **1 (800) 222-3111**. In Canada, dial **1 (866) 288-4268**.

The Skype name is a trademark of Skype.

Microsoft Lync is a registered trademark of Microsoft Corporation.

Quick reference guide - headset

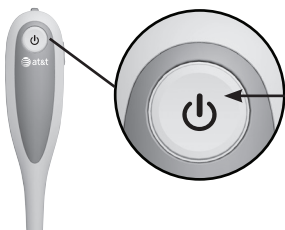

⏻ (On/off button and light)

Press to make, answer or end a call.



MUTE/VOICE

Press to mute the microphone during a call.

Press to mute the ringer in the earpiece when there is an incoming call.

Press to initiate the voice command feature when in idle mode.

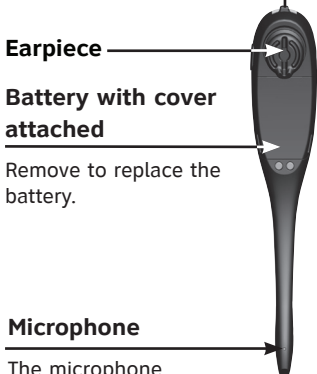

Earpiece

Battery with cover attached

Remove to replace the battery.

Microphone

The microphone incorporates noise canceling technology for clearer calls.

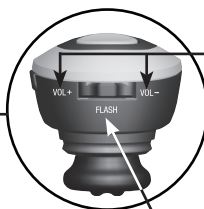

VOL+/VOL-

Slide the volume switch to the right or left to adjust the headset ringer volume while in idle mode, or the listening volume while on a call.

FLASH

Press to answer an incoming call when you receive a call waiting alert during a call.

Quick reference guide - headset base

Magnetic charging mount

Place the headset here for charging.

MUTE (light)

PHONE (mode button and light)

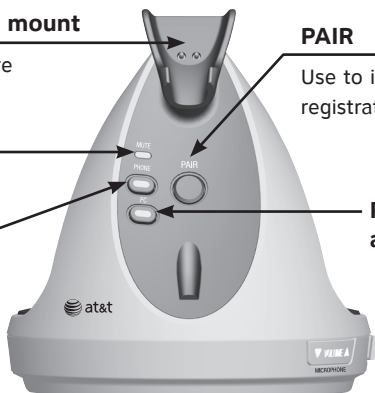

PAIR

Use to initiate headset registration or deregistration.

PC (mode button and light)

▼ VOLUME ▲/MICROPHONE

Press the volume keys on the side of the headset base to adjust the speaking volume when on a call.

USB (USB port)

Open the port cover to plug in the USB cable for use with PC mode.

LIFTER

This jack is only used to connect an AT&T handset lifter (model TL7100, purchased separately).

CORDED HANDSET CONNECTED/ YES/NO

Choose the setting based on whether you have connected to a corded handset.

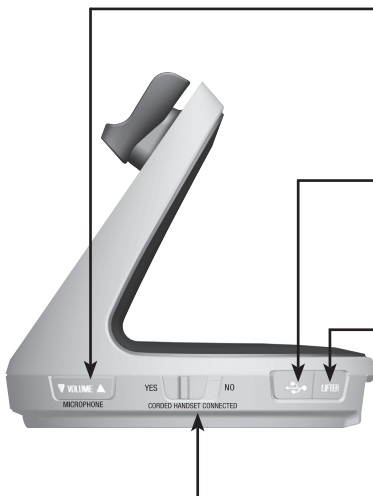

Quick reference guide - headset base



CORDED PHONE CONNECTION jack (blue dot)

This jack is only used to connect the corded phone connection cable.

TEL WALL JACK (red dot)

POWER jack (green dot)

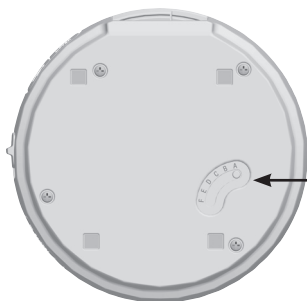

Corded handset audio adjust switch

Use this switch to adjust the corded handset audio when you have connected the headset base to a corded telephone.

Battery installation

The battery is permanently attached to the battery compartment cover. Do not try to separate them from each other. After installing the battery pack, charge it for at least 15 minutes. You may be able to make and receive short calls. For optimal performance, charge the headset battery for at least three hours before use. When fully charged, the headset battery provides approximately 12 hours of talk time or 5 days of standby time. When the headset is not in use, recharge it by returning it to the headset base.

1. Insert the battery pack into the battery compartment.

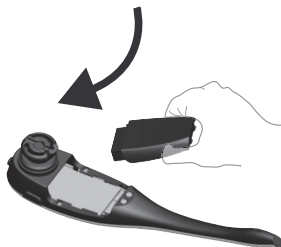

2. Press down on the battery pack until it clicks into place.

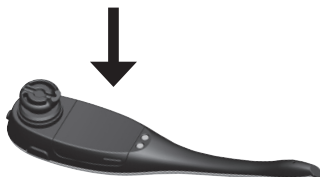

NOTES:

- Remove any headset attachment (earbud excluded) before battery replacement.
- To order a replacement battery pack (model BT191665), visit our website at **www.telephones.att.com** or call **1 (800) 222-3111**.
In Canada, dial **1 (866) 288-4268**.

Headset base installation and battery charging

After installing the battery, charge the headset by placing it in the magnetic charging mount as shown below. The  light turns on when the headset is charging.

1. Plug the small end of the headset base power adapter into the **POWER** jack (green dot) at the back of the headset base. Plug the large end into an electrical outlet not controlled by a wall switch.

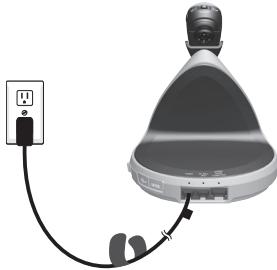

2. Insert the headset into the magnetic charging mount.



3. The magnet holds the top of the headset in place. The  light turns on.



IMPORTANT INFORMATION

Use only the supplied rechargeable battery pack or replacement battery pack (model BT191665). To order, visit our website at **www.telephones.att.com** or call **1 (800) 222-3111**. In Canada, dial **1 (866) 288-4268**.

Headset base installation

Installation options

There are three installation options as described below.

Option 1: Connect the headset to a telephone wall jack through the line splitter provided (see page 8).

Option 2: Connect the headset to a corded phone using the corded phone connection cable provided (see pages 9-10).

Option 3: Connect the headset to your computer using the USB cable provided for VoIP calls, and to the telephone wall jack using a telephone line cord for landline calls (see pages 11-13). Make sure you install the **AT&T Softphone Call Manager** on your computer using the **CD-ROM** provided in the package. You may also visit **www.telephones.att.com/downloads** to download and install the software. For installation and operation instructions of the software, refer to the **Installation and Operation Guide** which can also be found in the **CD-ROM** provided or the web site stated above.

Headset base installation

Option 1: Connect the headset to a telephone wall jack

1. Make sure the **CORDED HANDSET CONNECTED** switch on the right side of the headset base is set to **NO**.
2. Connect the line cords as shown below. Use the included line splitter to connect the headset base and your telephone to the same telephone wall jack.



- Plug one end of the telephone line cord into the **TEL WALL JACK** (red dot) at the back of the headset base.

- Use the attached fastener to bundle all line cords neatly.

- Connect another telephone line cord between the telephone and the line splitter.

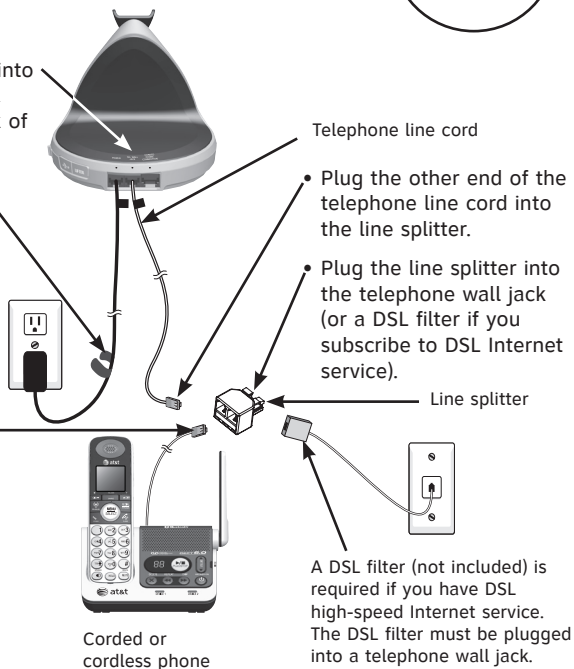

NOTE: The headset base and headset do not have external ringers. When you receive calls, the headset earpiece rings. If you have telephones connected to the same telephone line as the headset base, you can rely on the ringers of those telephones to alert you to incoming calls.

Headset base installation

Option 2: Connect the headset to a corded phone

1. Make sure the **CORDED HANDSET CONNECTED** switch on the right side of the headset base is set to **YES**.
2. Connect the line cords as shown below. Use the included corded phone connection cable to connect the headset base to your corded telephone.



- Use the attached fastener to bundle all line cords neatly.

A DSL filter (not included) is required if you have DSL high-speed Internet service. The DSL filter must be plugged into a telephone wall jack.

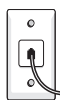

- Plug the other end of the corded phone connection cable into the handset jack on your corded phone.

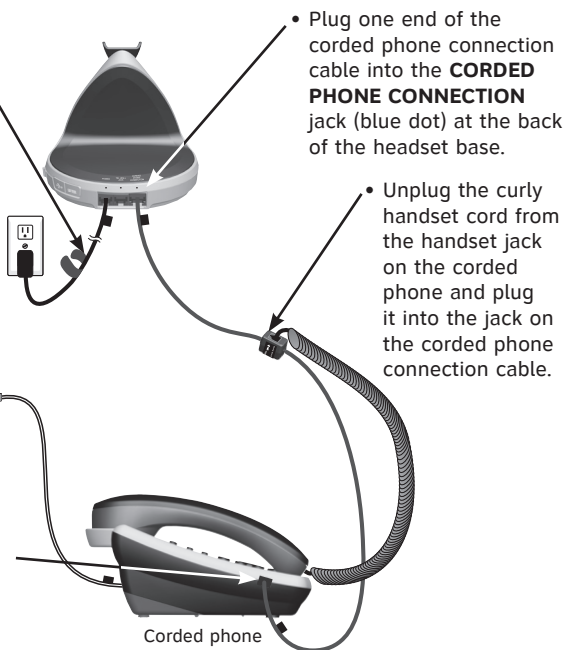

- Plug one end of the corded phone connection cable into the **CORDED PHONE CONNECTION** jack (blue dot) at the back of the headset base.

- Unplug the curly handset cord from the handset jack on the corded phone and plug it into the jack on the corded phone connection cable.

Corded phone

Headset base installation

Option 2: Connect the headset to a corded phone (cont.)

After you have connected the headset base to your corded phone, you may need to adjust the corded handset audio switch at the bottom of the headset base for optimal sound quality.

To adjust the corded handset audio:

- Lift the corded handset and then press **⓪** on the headset to check for a dial tone. If there is no dial tone or the dial tone is unclear, slide the corded handset audio switch at the bottom of the headset base from **A** to **F** until the dial tone is clear.

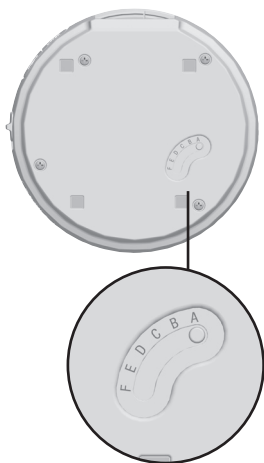

Headset base installation

Option 3: Connect the headset to your computer

1. Connect the headset base to your computer using the USB cable provided for VoIP calls. Plug the USB cable as shown below. Wait for your computer to indicate that it has recognized the headset.
2. Install the **AT&T Softphone Call Manager** using the **CD-ROM** provided in the package. You may also visit **www.telephones.att.com/downloads** to download and install the software. For installation and operation instructions of the software, refer to the **Installation and Operation Guide** which can also be found in the **CD-ROM** provided or the web site stated above.

A DSL filter (not included) is required if you have DSL high-speed Internet service. The DSL filter must be plugged into a telephone wall jack.

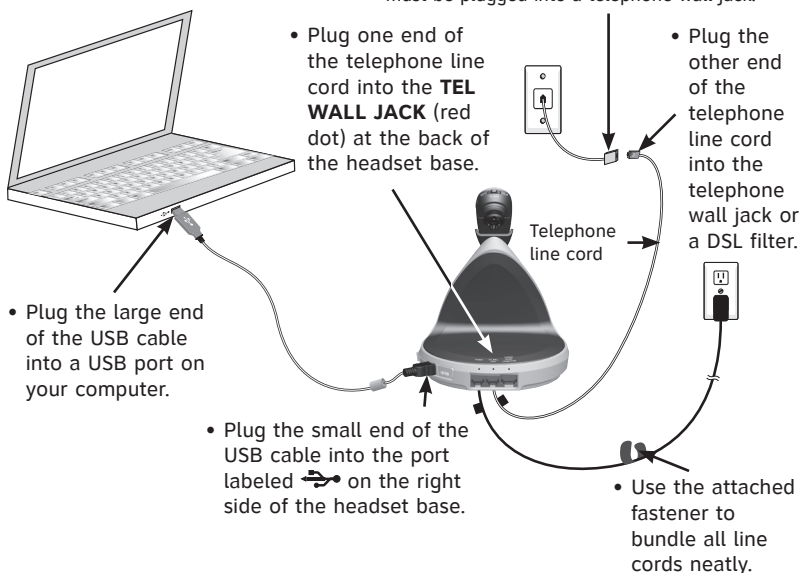

Headset base installation

Option 3: Connect the headset to your computer (cont.)

3. After you have installed the **AT&T Softphone Call Manager**, check to make sure the audio setting is properly configured in your Windows system. If you have installed Skype and/or Microsoft Lync and want to use them with your headset, make sure the audio settings are configured correctly in the programs as well.

a) Audio settings in Microsoft® Windows® system:

For Windows XP® users:

- i. Click **Start** menu and choose **Control Panel**.
- ii. Click **Sounds, Speech, and Audio Devices** and then click **Sounds and Audio Devices**.
- iii. Click the **Audio** tab.
- iv. Make sure **AT&T DECT Headset** is selected under the **Sound playback** and **Sound recording** settings.

For Windows 7 users:

- i. Click **Start** menu and choose **Control Panel**.
- ii. Click **Hardware and Sound** and then click **Manage audio devices** under the **Sound** menu.
- iii. Click the **Playback** tab and make sure **AT&T DECT Headset** is set as the default speaker.
- iv. Click the **Recording** tab and make sure **AT&T DECT Headset** is set as the default microphone.

Headset base installation

Option 3: Connect the headset to your computer (cont.)

b) Audio settings in Skype:

- i. Launch the Skype program.
- ii. Click on **Tools**, then **Options**.
- iii. Click on **Audio settings**.
- iv. Make sure **AT&T DECT Headset** is selected under the speakers and microphone settings.

c) Audio settings in Microsoft Lync:

- i. Launch the Microsoft Lync program.
- ii. Click on **Options**, then **Audio device**.
- iii. Make sure **AT&T DECT Headset** is selected under the Audio device setting.



IMPORTANT

Periodically check for software updates. Go to the **ABOUT** tab under the **Settings** panel in the **AT&T Softphone Call Manager**, then click **Check Update**. For more details, refer to the **Software updates** section in the **Installation and Operation Guide**, available in the **CD-ROM** which comes with the package.

Headset attachments

Earbud

There are a total of six earbuds provided. One of them has been attached to the headset. They come in three sizes of which there are two types: one normal and one providing a deeper fit. Follow the steps below to change the earbud.

To remove the earbud from the headset earpiece:

Hold both sides of the earbud. Twist and pull the earbud until it separates from the earpiece.

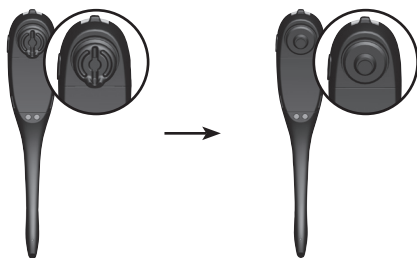

To attach the earbud to the headset earpiece:

1. Choose an appropriate earbud.
2. Position the earbud on the earpiece as shown below.
3. Press the earbud down on the earpiece until it clicks into place. Move the earbud around so that the protruding bump on the earbud is pointing towards your mouth when placed on your ear.

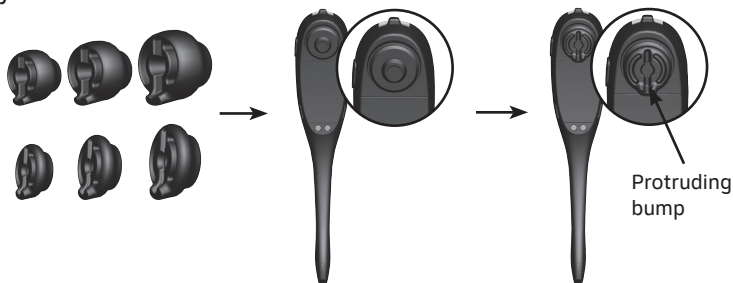

Headset attachments

Over the ear hook

There are three ear hooks provided. Choose the size that best fits your need to attach to the headset. Follow the steps below to attach an ear hook to the headset.

To position the headset to wear on the left or right ear:

- To wear on the left ear:
 1. Make sure the ear hook loop is positioned, as shown in Figure 1 on the right.
 2. Attach the ear hook to the headset, as instructed on the next page.



Figure 1

- To wear on the right ear:
 1. Make sure the ear hook loop is positioned, as shown in Figure 2 on the right.
 2. Attach the ear hook to the headset, as instructed on the next page.

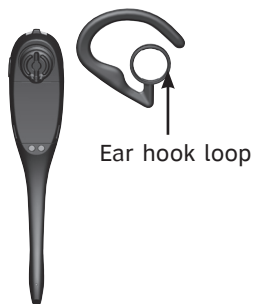

Figure 2

Headset attachments

To attach the ear hook to the headset:

1. Make sure there is no headset attachment, except the earbud, connected to the headset.
2. Insert the earpiece into the ear hook loop, as shown in Figure 3.
3. Press the edge of the ear hook loop towards the earpiece until it clicks into place, as shown in Figure 4.
4. Hook the headset onto the desired ear. Adjust the angle of the headset until the microphone is pointing towards your mouth, as shown in Figure 5.

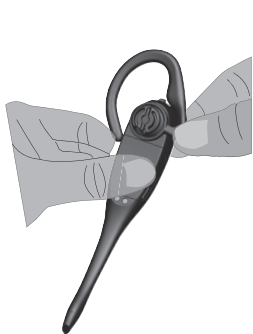

Figure 3

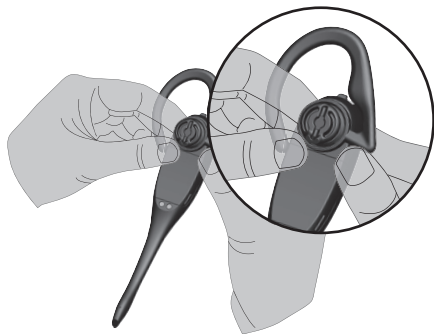

Figure 4

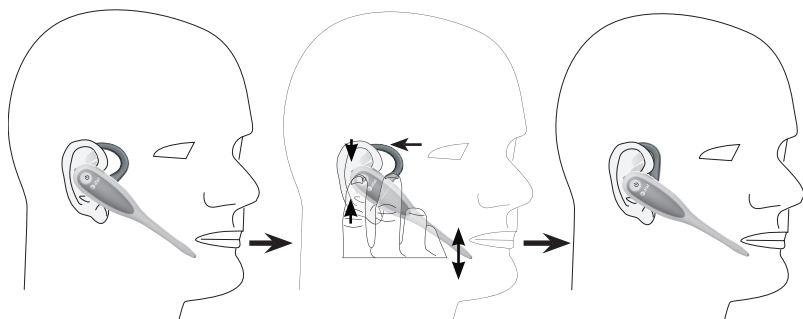

Figure 5

Headset attachments

Over the head band

There are two over the head bands provided. Choose the one that best fits your need to attach to the headset.

To attach the head band to the headset:

1. Make sure there is no headset attachment, except the earbud, connected to the headset.
2. Insert the earpiece into the loop of the ear pad, as shown in Figure 6.
3. Push the earpiece into the ear pad until it clicks into place, as shown in Figure 7.
4. Adjust the head band to fit your head. Adjust and rotate the angle of the headset until the microphone is pointing towards your mouth, as shown in Figure 8.

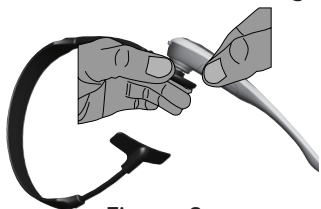

Figure 6

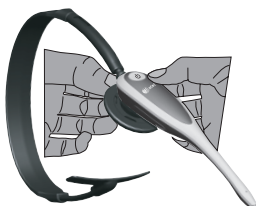

Figure 7

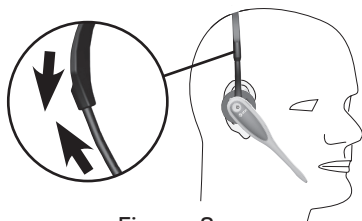

Figure 8



NOTES:

- To wear on the other ear, rotate the headset within the loop of the ear pad.
- Firmly grip the ear pad with one hand whenever adjusting the headset microphone up or down.

Headset attachments

Behind the neck band

To attach the headset to the neck band:

1. Make sure there is no headset attachment, except the earbud, connected to the headset.
2. Insert the earpiece into the loop of the ear pad, as shown in Figure 9.
3. Gently press the earpiece inward until it clicks into place, as shown in Figure 10.
4. Place the neck band around your neck and over your ears.
5. Adjust and rotate the angle of the headset until the microphone is pointing towards your mouth, as shown in Figure 11.



Figure 9



Figure 10

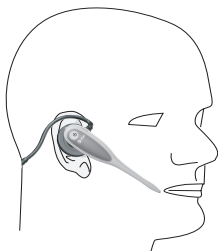



Figure 11

Headset operation

Power on/off the headset

Power on the headset before use.

To power on the headset:

- Place the headset in the headset base.
- **-OR-**
- Press and hold  for two seconds.

The  light flashes blue three times and you hear three beeps when it is being powered on.

Power off the headset if it will not be used for a long time.

To power off the headset:

- Press and hold  for four seconds.

The  light flashes red three times and you hear three beeps when it is being powered off.



Prolonged exposure to high volume levels using the headset may damage your hearing.

PHONE mode and PC mode

Before using the headset, you may change its default mode to PHONE mode or PC mode. When you press  on the headset while it is not in use, your headset automatically uses the default mode you selected. When the headset is not in use, you can choose between PHONE mode and PC mode.

To choose PHONE mode:

- Press the **PHONE** button on the headset base. The **PHONE** light turns on.

To choose PC mode:

- Press the **PC** button on the headset base. The **PC** light turns on.

PHONE mode

Make a call

To make calls on your home or office telephone line, press **PHONE** on the headset base for PHONE mode.

When the headset base is connected to a telephone wall jack (installation option 1):

1. Follow the instructions in your telephone user's manual for making calls.
2. Press **⓪** on the headset at any time to join the call.
3. After you join the call, you can hang up the telephone and continue the call on the headset.

When the headset base is connected to your corded phone (installation option 2):

1. Lift the corded handset from the telephone base, press **⓪** on the headset.
2. Follow the instructions in your telephone user's manual for making calls. Do not hang up the corded handset until you are ready to end the call.



NOTE: If you plug the headset into a telephone line without a telephone connected, you cannot make calls.

Answer a call

When the headset base is connected to a telephone wall jack (installation option 1):

- Press **⓪** on the headset.

When the headset base is connected to your corded phone (installation option 2):

1. Lift the corded handset from the telephone base.
2. Press **⓪** on the headset at any time to join the call. Do not hang up the corded handset until you are ready to end the call.

PHONE mode

End a call

When the headset base is connected to a telephone wall jack (installation option 1):

- Press **⏏** on the headset or place the headset in the headset base.

When the headset base is connected to your corded phone (installation option 2):

- Hang up the corded handset, then press **⏏** on the headset or place the headset in the headset base.



www.telephones.att.com

© 2012-2013 Advanced American Telephones. All Rights Reserved.
AT&T and the AT&T logo are trademarks of AT&T Intellectual Property licensed to
Advanced American Telephones, San Antonio, TX 78219.

The Skype name is a trademark of Skype.

Microsoft Lync is a registered trademark of Microsoft Corporation.
Windows® and Windows XP® are registered trademarks of Microsoft Corporation.

Printed in China. Issue 4 AT&T 06/13