



User's manual DM111/DM111-2

Safe & Sound™ audio monitor



Congratulations

on purchasing your new VTech product. Before using this product, please read **Important safety instructions** in this manual.

For support, shopping, and everything new at VTech, visit our website at www.vtechphones.com. In Canada, please visit www.vtechcanada.com.

Register online to get an additional 3-month warranty!

Visit www.vtechphones.com.



Registration

Register your product online for enhanced warranty support.



Product news

Learn about the latest VTech products.

Important safety instructions

When using your equipment, basic safety precautions should always be followed to reduce the risk of fire, electric shock and injury, including the following:

- Follow all warnings and instructions marked on the product.
- Adult setup is required.
- This product is intended as an aid. It is not a substitute for responsible and proper adult supervision and should not be used as such.
- This product is not intended for use as a medical monitor.
- Do not use this product near water. For example, do not use it next to a bath tub, wash bowl, kitchen sink, laundry tub or swimming pool, or in a wet basement or shower.
- CAUTION:** Use only alkaline batteries (not included). There may be a risk of explosion if a wrong type of battery is used for the parent unit. Do not dispose of batteries in a fire. They may explode. Check with local codes for possible special disposal instructions.
- Do not open or mutilate the batteries. Released electrolyte is corrosive and may cause burns or injury to the eyes or skin. The electrolyte may be toxic if swallowed.
- Exercise care in handling the batteries in order not to create a short circuit with conductive materials.
- Observe proper polarity orientation between the batteries and metallic contacts.
- Use only the adapters included with this product. Incorrect adapter polarity or voltage can seriously damage the product.
Baby unit power adapter: Input 117V AC 60 Hz; output: 6V AC 300 mA
Parent unit power adapter: Input 100-120V AC 60 Hz; output: 6V DC 400 mA
- The power adapters are intended to be correctly oriented in a vertical or floor mount position. The prongs are not designed to hold the plug in place if it is plugged into a ceiling, under-the-table or cabinet outlet.
- Unplug this product from the wall outlet before cleaning. Do not use liquid or aerosol cleaners. Use a damp cloth for cleaning.
- Unplug the power cords before replacing the batteries.
- Do not cut off the adapters to replace them with other plugs, as this causes a hazardous situation.
- Do not allow anything to rest on the power cords. Do not install this product where the cords may be walked on or crimped.
- This product should be operated only from the type of power source indicated on the marking label. If you are not sure of the type of power supply in your home, consult your dealer or local power company.
- Do not overload wall outlets or use an extension cord.
- Do not place this product on an unstable table, shelf, stand or other unstable surfaces.
- This product should not be placed in any area where proper ventilation is not provided. Slots and openings in the back or bottom of this product are provided for ventilation. To protect them from overheating, these openings must not be blocked by placing the product on a soft surface such as a bed, sofa or rug. This product should never be placed near or over a radiator or heat register.
- Never push objects of any kind into this product through the slots because they may touch dangerous voltage points or create a short circuit. Never spill liquid of any kind on the product.
- To prevent fire or shock hazard, do not expose this product to water or any type of moisture.
- To reduce the risk of electric shock, do not disassemble this product, but take it to an authorized service facility. Opening or removing parts of the product other than specified access doors may expose you to dangerous voltages or other risks. Incorrect reassembling can cause electric shock when the product is subsequently used.
- You should test the sound reception every time you turn on the units or move one of the components.
- Periodically examine all components for damage.
- Be aware of possible loss of privacy while using public airwaves. Conversations may be picked up by other nursery monitors, cordless phones, scanners, etc.
- Children should be supervised to ensure that they do not play with the product.
- The product is not intended for use by persons (including children) with reduced physical, sensory or mental capabilities, or lack of experience and knowledge, unless they have been given supervision or instruction concerning use of the appliance by a person responsible for their safety.

SAVE THESE INSTRUCTIONS

Cautions

- Use and store the product at a temperature between 32°F and 104°F.
- Do not expose the product to extreme cold, heat or direct sunlight. Do not put the product close to a heating source.
- The batteries should not be exposed to excessive heat such as bright sunshine or fire.
- Make sure the baby unit and the adapter cord are always out of reach of the baby, at least 1 meter (3 feet) away from the baby or crib, to avoid a possible strangulation hazard.
- Other electronic products may cause interference with your audio monitor. Try installing your audio monitor as far away from these electronic devices as possible: wireless routers, radios, cellular telephones, intercoms, room monitors, televisions, personal computers, kitchen appliances and cordless telephones.

- Never place the baby unit inside the baby's crib or playpen.
- Never cover the baby unit or parent unit(s) with anything such as a towel or a blanket.

Precautions for users of implanted cardiac pacemakers

Cardiac pacemakers (applies only to digital cordless devices):

Wireless Technology Research, LLC (WTR), an independent research entity, led a multidisciplinary evaluation of the interference between portable wireless devices and implanted cardiac pacemakers. Supported by the U.S. Food and Drug Administration, WTR recommends to physicians that:

Pacemaker patients

- Should keep wireless devices at least six inches from the pacemaker.
- Should NOT place wireless devices directly over the pacemaker, such as in a breast pocket, when it is turned ON.

WTR's evaluation did not identify any risk to bystanders with pacemakers from other persons using wireless devices.

Electromagnetic fields (EMF)

This VTech product complies with all standards regarding electromagnetic fields (EMF). If handled properly and according to the instructions in this user's manual, the product is safe to be used based on scientific evidence available today.

Parts checklist

- Baby unit (DM111 BU/DM111-2 BU)
- Parent unit (DM111 PU/DM111-2 PU) (1 for DM111 and 2 for DM111-2)
- Power adapter for baby unit
- Power adapter for parent unit (1 for DM111 and 2 for DM111-2)
- User's manual

Connect

note

- Use only the parent unit power adapter and the baby unit power adapter supplied with this product.
- The parent unit power adapter and baby unit power adapter are intended for a vertical or floor mount position. The prongs are not designed to hold the plug in place if it is plugged into a ceiling, under-the-table, or cabinet outlet.
- Make sure the parent unit, the baby unit and the power adapter cord are out of reach of children.
- Both the baby unit and the parent unit are on once connected to the power supply.

Connect the baby unit

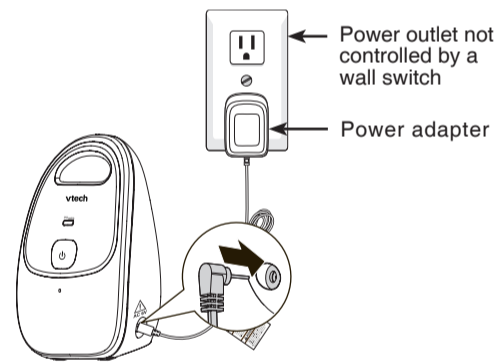

Connect the parent unit

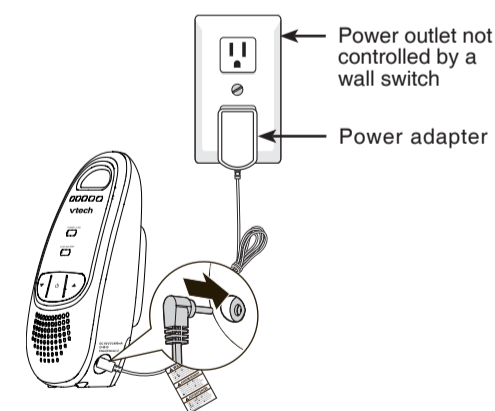

Positioning the baby monitor

Place the parent unit within the operating range of the baby unit. We recommend the parent unit is at least 1 meter (3 feet) away from the baby unit to avoid audio feedback. If you still experience audio feedback, move the parent unit and the baby unit farther apart.

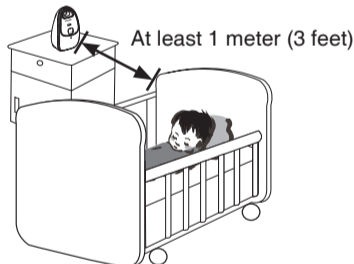

Operating range

The operating range of the baby monitor is up to 300 meters (1000 feet) outdoors or 50 meters (160 feet) indoors. The actual operating range may vary depending on the environmental conditions, and other interferences such as walls, doors, and other obstructions.

Overview

Baby unit overview

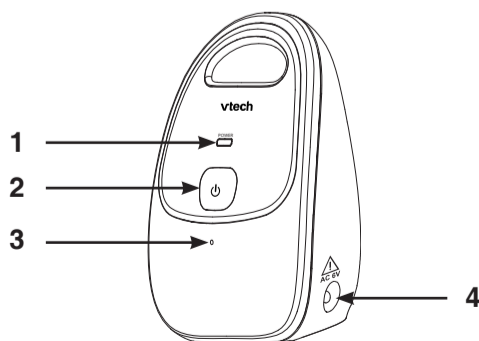

- POWER light**
- (On/off)**
Press and hold to turn on or off the baby unit.
- Microphone**
- Power jack**

Parent unit overview

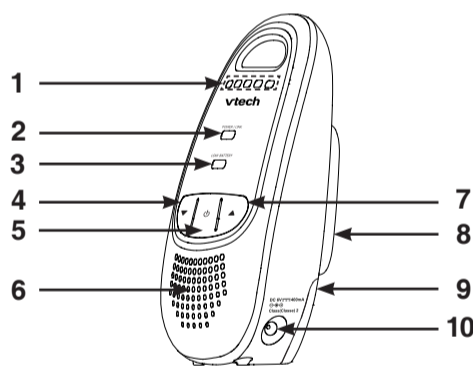

- Visual sound indicator**
- POWER/LINK light**
- LOW BATTERY light**
- ▼ (Volume down)**
Press to decrease the speaker volume.
- (On/off)**
Press and hold to turn on or off the parent unit.
- Speaker**
Listen to sounds transmitted from the baby unit.
- ▲ (Volume up)**
Press to increase the speaker volume.
- Belt clip**
- Battery compartment cover**
- Power jack**

Baby unit light

	POWER light
	<ul style="list-style-type: none"> Lights off when the baby unit is off. Lights on in green when the baby unit is on.

Parent unit light

	POWER/LINK light
	<ul style="list-style-type: none"> Lights off when the parent unit is off. Lights on in green when the parent unit is on and linked to the baby unit. Flashes in green when there is no link between the baby unit and parent unit, or when the parent unit is out of range from the baby unit.
	Visual sound indicator
	<p>The visual sound indicator shows the sound level detected from the baby unit. It also shows the volume level during speaker volume setting.</p> <p>Sound level detected from the baby unit is independent from the volume level set at the parent unit.</p> <ul style="list-style-type: none"> Green lights indicate a moderate sound level detected from the baby unit; or Level 1 to Level 3 of the speaker volume setting. Red lights indicate a higher sound level detected from the baby unit; or Level 4 to Level 5 of the speaker volume setting.
	LOW BATTERY light
	<ul style="list-style-type: none"> Flashes in red when the battery is low.

Before use

You may test the baby monitor before initial use, and at regular times thereafter.

To test your baby monitor:

- Place the parent unit and the baby unit in the same room to test the product.
- Press and hold (On/off) on the baby unit until the **POWER** light turns off.
- Press and hold (On/off) on the baby unit again until the **POWER** light turns on.
- Press and hold (On/off) on the parent unit the **POWER/LINK** light turns off.
- Press and hold (On/off) on the parent unit again until the **POWER/LINK** light turns on.

note

- If the parent unit is not linked to the baby unit, the **POWER/LINK** light on the parent unit will flash. Move the parent unit closer to the baby unit (but not less than 1 meter / 3 feet).

Using your baby monitor

Power on or off the baby unit

To turn on the baby unit:

- Press and hold (On/off) until the **POWER** light turns on.

To turn off the baby unit:

- Press and hold (On/off) until the **POWER** light turns off.

Power on or off the parent unit

To turn on the parent unit:

- Press and hold (On/off) until the **POWER/LINK** light turns on.

To turn off the parent unit:

- Press and hold (On/off) until the **POWER/LINK** light turns off.

Speaker volume of the parent unit

The speaker volume is preset to **Level 3** on the parent unit. You can adjust to your preferred sound level.

To adjust the speaker volume:

- Press ▼ to decrease the volume, and ▲ to increase the volume.

- note**
- If you continue to press ▼ or ▲ even the volume reaches the minimum or maximum setting, the parent unit will sound once.
 - When the parent unit is in mute, the visual sound indicator will still indicate the sound detected from the baby unit.

Portable use of the parent unit (optional)

Install the batteries on the parent unit

- note**
- Use only the AAA alkaline batteries (not included).
 - When the batteries are installed, the parent unit turns on.
 - The parent unit does not support recharging.

- Slide open the battery compartment cover.
- Flip the ribbon across the battery compartment.

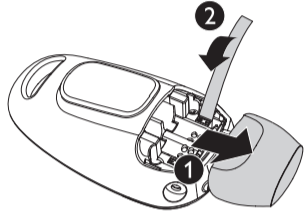

- Insert two AAA alkaline batteries into the battery compartment on top of the ribbon.
- Slide the battery compartment cover until it clicks into place.

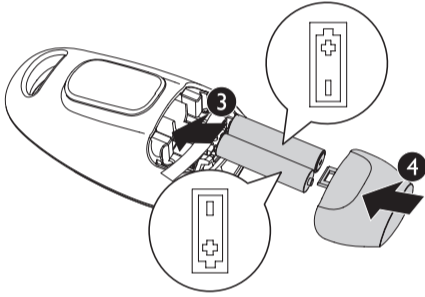

Standby mode

The parent unit is on standby mode when:

- it is not connected to the AC power supply; and
- there is no sound detected from the baby unit.

The standby time varies depending on usage and the battery life. Full batteries can last up to 8 days.

Replace the batteries when:

- LOW BATTERY** light flashes on the parent unit.
- The parent unit beeps twice every 30 seconds.
- The batteries are properly installed into the parent unit, but the **POWER/LINK** light on the parent unit is off.

Storage

When you are not going to use the baby monitor for some time, remove the batteries from the parent unit. Store the parent unit, the baby unit and the adapters in a cool and dry place.

General product care

To clean and maintain this product:

- Avoid putting it near heating appliances and devices that generate electrical noise (for example, motors or fluorescent lamps).
- DO NOT expose it to direct sunlight or moisture.
- Avoid dropping the product or treating it roughly.
- Clean with a soft cloth.
- DO NOT immerse the parent unit and the baby unit in water and do not clean them under the tap.
- DO NOT use cleaning spray or liquid cleaners.
- Make sure the baby unit and parent unit are dry before you connect them to the power supply.

Operating range

This product operates with the maximum power allowed by the Federal Communications Commission (FCC). Even so, the baby unit and the parent unit can communicate over only a certain distance - which can vary with the locations of the baby unit, the parent unit, the weather, and the layout of your home.

When the parent unit is out of range, it will beep three times every 10 seconds and enter searching mode.

To improve reception, move closer to the baby unit (but not less than 1 meter / 3 feet).

Frequently asked questions

Below are the questions most frequently asked about the baby monitor. If you cannot find the answer to your question, contact customer service by visiting our website at www.vtechphones.com or calling **1 (800) 595-9511**. In Canada, go to www.vtechcanada.com or call **1 (800) 267-7377**.

Why does the baby monitor not respond normally?	Try the following (in the order listed) for common sure: 1. Disconnect the power from the baby unit and the parent unit. 2. Remove the batteries from the parent unit. 3. Connect the baby unit to the power supply again. The baby unit turns on. 4. Connect the parent unit to the power supply again; or insert two new AAA alkaline batteries. The parent unit turns on. 5. Wait for the parent unit to synchronize with the baby units. Allow up to one minute for this to take place.
Why doesn't the POWER light on the baby unit turn on when I switch on the units?	Perhaps the baby unit is not connected to the power supply. Connect the baby unit to power supply. The baby unit turns on.
Why doesn't the POWER/LINK light on the parent unit turn on when I switch on the units?	Perhaps the battery of the parent unit is empty and the parent unit is not connected to power supply. Connect the parent unit to power supply; or insert two new AAA alkaline batteries into the parent unit. The parent unit turns on and establishes connection with the baby unit.
Why does the baby monitor produce a high-pitched noise?	The units may be too close to each other. Make sure the parent unit and the baby unit at least 1 meter (3 feet) away from each other.
Why does the parent unit react too quickly to other sounds?	The baby unit also picks up other sounds than those of your baby. Adjust the speaker volume on the parent unit.

Why don't I hear a sound/Why can't I hear my baby cry?	You may have muted the volume or set it to a lower level. You may need to adjust the volume to a higher level.
Why does the parent unit beep?	The baby units may be out of range. Move the parent unit closer to the baby units (but not less than 1 meter / 3 feet).
Why does the parent unit LOW BATTERY light flash?	When the parent unit is powered by batteries, there is not sufficient power for the parent unit to perform normally. Replace with two new AAA alkaline batteries.
Why can't I establish a connection? Why is the connection lost every now and then? Why are there sound interruptions?	The baby units may be out of range. Move the parent unit closer to the baby units (but not less than 1 meter / 3 feet). Other electronic products may cause interference with your baby monitor. Try installing your baby monitor as far away from these electronic devices as possible.

FCC and IC regulations

FCC Part 15

This equipment has been tested and found to comply with the requirements for a Class B digital device under Part 15 of the Federal Communications Commission (FCC) rules. These requirements are intended to provide reasonable protection against harmful interference in a residential installation. This equipment generates, uses and can radiate radio frequency energy and, if not installed and used in accordance with the instructions, may cause harmful interference to radio communications. However, there is no guarantee that interference will not occur in a particular installation. If this equipment does cause harmful interference to radio or television reception, which can be determined by turning the equipment off and on, the user is encouraged to try to correct the interference by one or more of the following measures:

- Reorient or relocate the receiving antenna.
- Increase the separation between the equipment and receiver.
- Connect the equipment into an outlet on a circuit different from that to which the receiver is connected.
- Consult the dealer or an experienced radio/TV technician for help.

Changes or modifications to this equipment not expressly approved by the party responsible for compliance could void the user's authority to operate the equipment.

This device complies with Part 15 of the FCC rules. Operation is subject to the following two conditions: (1) this device may not cause harmful interference, and (2) this device must accept any interference received, including interference that may cause undesired operation.

To ensure safety of users, the FCC has established criteria for the amount of radio frequency energy that can be safely absorbed by a user or bystander according to the intended usage of the product. This product has been tested and found to comply with the FCC criteria. The baby unit shall be installed and used such that parts of all persons' body are maintained at a distance of approximately 20 cm (8 inches) or more.

This Class B digital apparatus complies with Canadian requirement:
CAN ICES-3 (B)/NMB-3(B)

For body worn operation, this parent unit has been tested and meets the FCC RF exposure guidelines when used with the accessories supplied or designated for this product. Use of other accessories may not ensure compliance with FCC RF exposure guidelines.

Industry Canada

Operation is subject to the following two conditions: (1) this device may not cause harmful interference, and (2) this device must accept any interference, including interference that may cause undesired operation.

The term "IC:" before the certification/registration number only signifies that the Industry Canada technical specifications were met.

This product meets the applicable Industry Canada technical specifications.

RF radiation exposure statement

The baby unit complies with FCC RF radiation exposure limits set forth for an uncontrolled environment. The baby unit should be installed and operated with a minimum distance of 20 cm (8 inches) between the baby unit and all persons' body. Use of other accessories may not ensure compliance with FCC RF exposure guidelines. This transmitter must not be co-located or operating in conjunction with any other antenna or transmitter. This equipment complies also with Industry Canada RSS-102 with respect to Canada's Health Code 6 for Exposure of Humans to RF Fields.

Limited warranty

What does this limited warranty cover?

The manufacturer of this VTech Product warrants to the holder of a valid proof of purchase ("Consumer" or "you") that the Product and all accessories provided in the sales package ("Product") are free from defects in material and workmanship, pursuant to the following terms and conditions, when installed and used normally and in accordance with the Product operating instructions. This limited warranty extends only to the Consumer for Products purchased and used in the United States of America and Canada.

What will VTech do if the Product is not free from defects in materials and workmanship during the limited warranty period ("Materially Defective Product")?

During the limited warranty period, VTech's authorized service representative will repair or replace at VTech's option, without charge, a Materially Defective Product. If we repair the Product, we may use new or refurbished replacement parts. If we choose to replace the Product, we may replace it with a new or refurbished Product of the same or similar design. We will retain defective parts, modules, or equipment. Repair or replacement of the Product, at VTech's option, is your exclusive remedy. VTech will return the repaired or replacement Products to you in working condition. You should expect the repair or replacement to take approximately 30 days.

How long is the limited warranty period?

The limited warranty period for the Product extends for ONE (1) YEAR from the date of purchase. If VTech repairs or replaces a Materially Defective Product under the terms of this limited warranty, this limited warranty also applies to the repaired or replacement Product for a period of either (a) 90 days from the date the repaired or replacement Product is shipped to you or (b) the time remaining on the original one-year warranty; whichever is longer.

What is not covered by this limited warranty?

This limited warranty does not cover:

- Product that has been subjected to misuse, accident, shipping or other physical damage, improper installation, abnormal operation or handling, neglect, inundation, fire, water or other liquid intrusion; or
- Product that has been damaged due to repair, alteration or modification by anyone other than an authorized service representative of VTech; or
- Product to the extent that the problem experienced is caused by signal conditions, network reliability, or cable or antenna systems; or
- Product to the extent that the problem is caused by use with non-VTech accessories; or

- Product whose warranty/quality stickers, product serial number plates or electronic serial numbers have been removed, altered or rendered illegible; or
- Product purchased, used, serviced, or shipped for repair from outside the United States of America or Canada, or used for commercial or institutional purposes (including but not limited to Products used for rental purposes); or
- Product returned without a valid proof of purchase (see item 2 on the next page); or
- Charges for installation or set up, adjustment of customer controls, and installation or repair of systems outside the unit.

How do you get warranty service?

To obtain warranty service in the United States of America, visit www.vtechphones.com or call **1 (800) 595-9511**. In Canada, go to www.vtechcanada.com or call **1 (800) 267-7377**.

NOTE: Before calling for service, please review the user's manual - a check of the Product's controls and features may save you a service call.

Except as provided by applicable law, you assume the risk of loss or damage during transit and transportation and are responsible for delivery or handling charges incurred in the transport of the Product(s) to the service location. VTech will return repaired or replaced Product under this limited warranty. Transportation, delivery or handling charges are prepaid. VTech assumes no risk for damage or loss of the Product in transit. If the Product failure is not covered by this limited warranty, or proof of purchase does not meet the terms of this limited warranty, VTech will notify you and will request that you authorize the cost of repair prior to any further repair activity. You must pay for the cost of repair and return shipping costs for the repair of Products that are not covered by this limited warranty.

What must you return with the Product to get warranty service?

- Return the entire original package and contents including the Product to the VTech service location along with a description of the malfunction or difficulty; and
- Include a "valid proof of purchase" (sales receipt) identifying the Product purchased (Product model) and the date of purchase or receipt; and
- Provide your name, complete and correct mailing address, and telephone number.

Other limitations

This warranty is the complete and exclusive agreement between you and VTech. It supersedes all other written or oral communications related to this Product. VTech provides no other warranties for this Product. The warranty exclusively describes all of VTech's responsibilities regarding the Product. There are no other express warranties. No one is authorized to make modifications to this limited warranty and you should not rely on any such modification.

State/Provincial Law Rights: This warranty gives you specific legal rights, and you may also have other rights, which vary from state to state or province to province.

Limitations: Implied warranties, including those of fitness for a particular purpose and merchantability (an unwritten warranty that the Product is fit for ordinary use) are limited to one year from the date of purchase. Some states/provinces do not allow limitations on how long an implied warranty lasts, so the above limitation may not apply to you. In no event shall VTech be liable for any indirect, special, incidental, consequential, or similar damages (including, but not limited to lost profits or revenue, inability to use the Product or other associated equipment, the cost of substitute equipment, and claims by third parties) resulting from the use of this Product. Some states/provinces do not allow the exclusion or limitation of incidental or consequential damages, so the above limitation or exclusion may not apply to you.

Please retain your original sales receipt as proof of purchase.

Technical specifications

Frequency control	Crystal controlled PLL synthesizer
Transmit frequency	Baby unit: 1921.536-1928.448 MHz Parent unit: 1921.536-1928.448 MHz
Channels	5
Nominal effective range	Maximum power allowed by FCC and IC. Actual operating range may vary according to environmental conditions at the time of use.
Power requirements	Baby unit adapter: Input: 117V AC 60Hz Output: 6V AC @ 300mA Parent unit adapter: Input: 100-120V AC 60Hz Output: 6V DC @ 400mA Parent unit battery: 2 X AAA alkaline batteries

VTECH TELECOMMUNICATIONS LTD.
A member of THE VTECH GROUP OF COMPANIES.
Distributed in the U.S.A. by VTech Communications, Inc., Beaverton, Oregon 97008.
Distributed in Canada by VTech Technologies Canada Ltd., Richmond, B.C. V6W 1L5.
VTech is the registered trademark of VTech Holdings Limited.
Copyright © 2013 for VTECH TELECOMMUNICATIONS LTD.
All rights reserved. Printed in China. Version 2 10/13.
91-007297-020-100