

Go to [www.vtechphones.com](http://www.vtechphones.com) to register your product for enhanced warranty support and the latest VTech product news.

VM3251  
VM3251-2

## Video Monitor with Adjustable Lens



# vtech

## User's manual

### Congratulations

on purchasing your new VTech product. Before using this product, please read **Important safety instructions**.

This manual has all the feature operations and troubleshooting necessary to install and operate your new VTech product. Please review this manual thoroughly to ensure proper installation and operation of this innovative and feature rich VTech product.

For support, shopping, and everything new at VTech, visit our website at [www.vtechphones.com](http://www.vtechphones.com).

### What's in the box

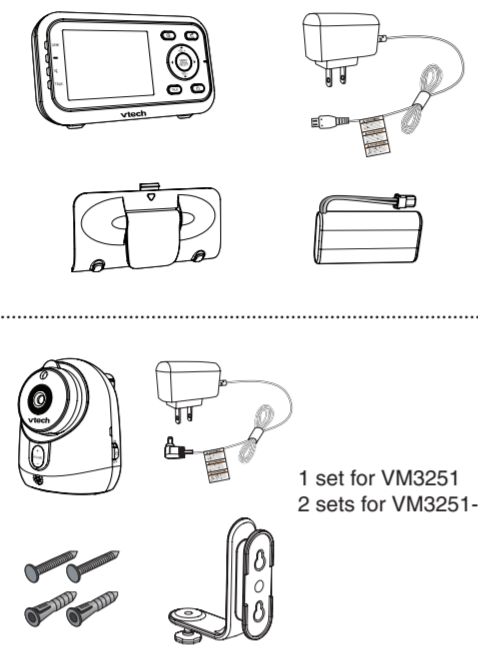

1 set for VM3251  
2 sets for VM3251-2

### Install the battery

The parent unit runs on rechargeable battery or AC power. To continuously monitor your baby, make sure you use both battery and AC power at the same time. With the battery alone, the parent unit can cordlessly run for a short time only.

#### NOTES

- Use only the power adapters supplied with this product.
- Make sure the electrical outlets are not controlled by wall switches.
- The power adapters are intended to be correctly oriented in a vertical or floor mount position. The prongs are not designed to hold the plug in place if they are plugged into a ceiling, under-the-table or cabinet outlet.
- Make sure the parent unit, the baby unit and the power adapter cords are out of reach of children.

Install the battery as shown below.

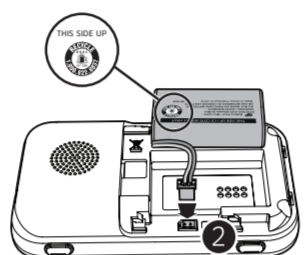
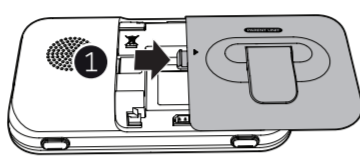

#### NOTE

- Make sure the label **THIS SIDE UP** is facing up while inserting the battery.

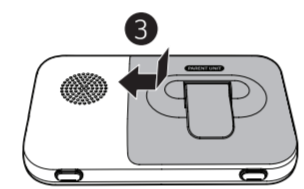

### Replace the battery

To replace the battery, pull out the battery compartment cover, and then lift up the battery. Follow the steps above to install the new battery.

### Connect and charge the battery

#### NOTES

- Use only the power adapters supplied with this product.
- Make sure the electrical outlets are not controlled by wall switches.
- The power adapters are intended to be correctly oriented in a vertical or floor mount position. The prongs are not designed to hold the plug in place if they are plugged into a ceiling, under-the-table or cabinet outlet.
- Make sure the parent unit, the baby unit and the power adapter cords are out of reach of children.

### Connect the baby monitor

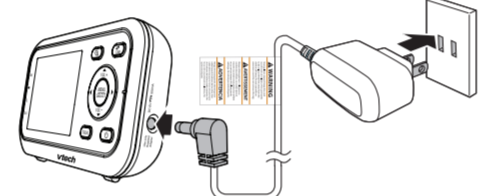
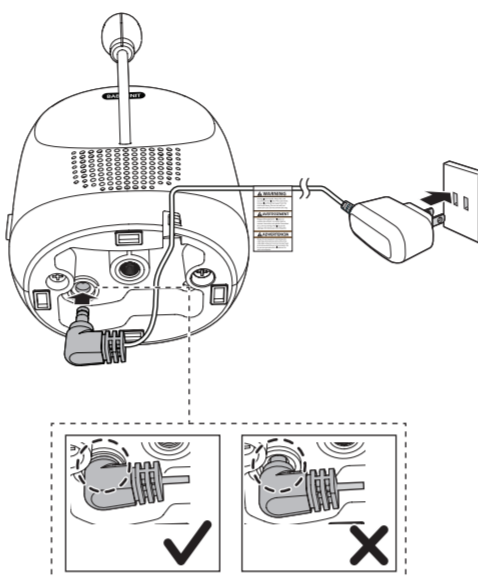

### Charge the parent unit battery

When you have connected the parent unit and installed its battery for the first time or after power outage, the parent unit powers on automatically. The battery icon indicates the battery status (see the following table).

#### NOTES

- The parent unit battery is fully charged after 11 hours of continuous charging.
- It takes longer to charge the battery when the parent unit is turned on. To shorten the charging time, turn the parent unit off while charging.
- The standby time varies depending on the volume level you set, your actual use and the age of the battery.

| Battery indicators  | Battery status  | Action  |
|---|---|---|
| The battery icon is off and  displays.  | No battery is installed but operates using AC power, or the battery has been installed incorrectly. | Install the parent unit battery. Charge without interruption (at least 30 minutes). |
| The screen displays <b>Battery low at Parent Unit</b> and . The  light flashes. | The battery has very little charge and may be used for only a short time.                           | Charge without interruption (about 30 minutes).                                     |
| The battery icon becomes solid .  | The battery is fully charged.   | To keep the battery charged, connect it to AC power when not in use.                |

### Before use

#### NOTE

- This baby monitor is intended as an aid. It is not a substitute for proper adult supervision, and should not be used as such.

### Test your baby monitor

You may test the baby monitor before initial use, and at regular times thereafter.

#### CAUTION

- For hearing protection, make sure the parent unit is more than 1 meter (3 feet) away from both baby units. If you hear any high-pitched noise, move the parent unit further until the noise stops. You can also press **VOL-** on the parent unit to lower or mute the noise.

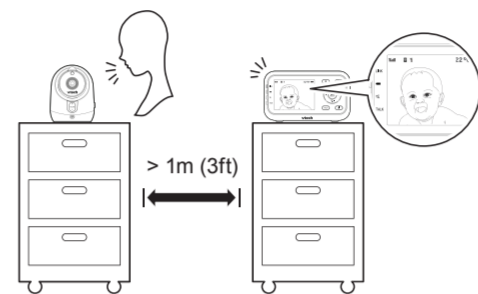

1. Make sure your baby units and parent unit are on.
2. The parent unit displays images from the baby unit.
  - Speak towards the microphone of the baby unit. You will hear the sound at the parent unit.
3. If you have more than one baby unit, press **CAM** at the right side of your parent unit. The screen switches to other baby units. Then, repeat step 2.

#### NOTE

- When the parent unit displays **No link to Camera**, and the **LINK** LED light flashes, move the parent unit closer to the baby units (observe the minimum distance of 1 meter/ 3 feet). You can also check if the baby monitor is connected to a live power socket and switched on.

#### TIP

- Increase the speaker volume of the parent unit if you cannot hear the sounds transmitted from the baby units.

### Positioning the baby monitor

#### CAUTION

- Keep the baby unit out of the reach of your baby. Never place or mount the baby unit inside the baby's crib or playpen.
- To avoid interference from other electronic devices, place your baby monitor far away from devices such as wireless routers, microwaves, cell phones and computers.

1. Place the baby units more than 1 meter (3 feet) away from your baby.

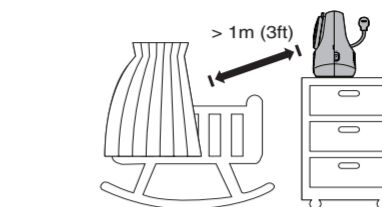

2. Place the parent unit more than 1 meter (3 feet) away from the baby units.

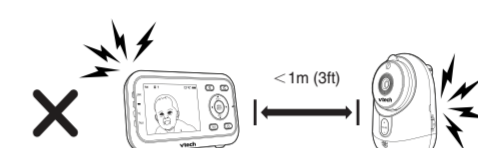
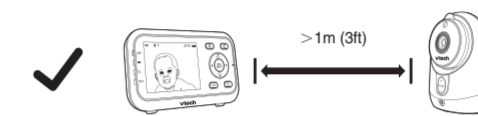

3. Flip down the camera on the baby unit to adjust the angle according to your preference.



#### CAUTION

- The default volume of your parent unit is level 4. If you experience high-pitched screaming noise from your baby monitor while positioning:
  - Make sure your baby units and parent unit are more than 1 meter (3 feet) apart, OR
  - Turn down the volume of your parent unit.

### Operating range

The operating range of the baby monitor is up to 300 meters (1,000 feet) outdoors or 50 meters (160 feet) indoors. The actual operating range may vary depending on the environmental conditions and other interferences such as walls, doors and other obstructions.

### Overview

#### Baby unit overview

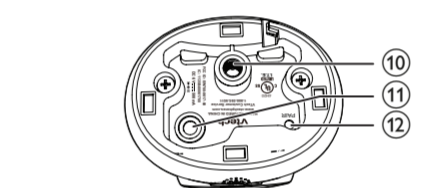
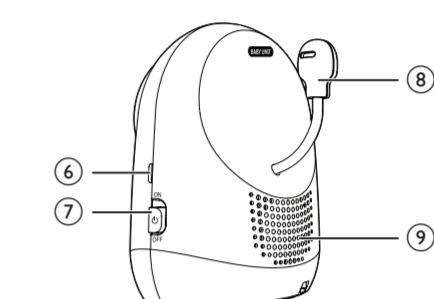
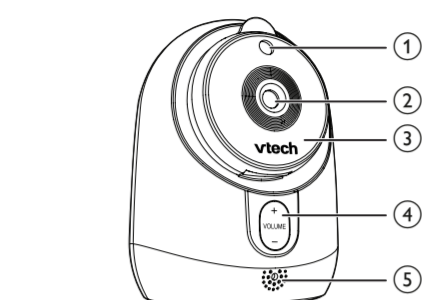

|    |   |
|----|---|
| 1  | Light sensor  |
| 2  | Camera  |
| 3  | Infrared LEDs   |
| 4  | -/VOLUME/+ <ul style="list-style-type: none"> <li>• Press to adjust the speaker volume. It determines the talkback volume transmitted from your parent unit.</li> </ul>   |
| 5  | Microphone  |
| 6  | ON/OFF LED light <ul style="list-style-type: none"> <li>• On when the baby unit is turned on and is paired to the parent unit.</li> <li>• Flashes when the baby unit is not being viewed; or when the link to the parent unit is lost.</li> </ul> |
| 7  | ON/OFF switch <ul style="list-style-type: none"> <li>• Slide to turn on or off the baby unit.</li> </ul>  |
| 8  | Temperature sensor  |
| 9  | Speaker   |
| 10 | Threaded socket <ul style="list-style-type: none"> <li>• For wall mount installation use.</li> </ul>  |
| 11 | Power Jack  |
| 12 | PAIR <ul style="list-style-type: none"> <li>• Your baby units and parent unit provided are already paired.</li> <li>• Press on the accessory baby units (VM3211, purchased separately) to pair to the parent unit.</li> </ul>                     |

### Parent unit overview

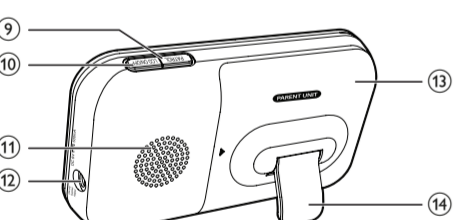
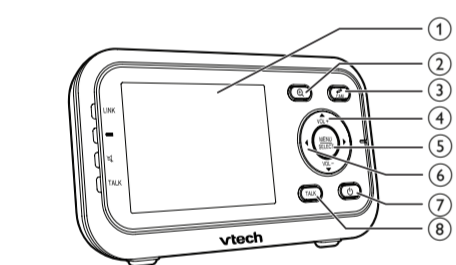

|   |  |
|---|--|
| 1 | LCD display  |
| 2 | Zoom <ul style="list-style-type: none"> <li>• Press to zoom in or out while viewing image in <b>SINGLE-CAM</b> or <b>PATROL</b> mode.</li> </ul>   |
| 3 | CAM <ul style="list-style-type: none"> <li>• Press to change the screen to view images from different baby units.</li> </ul>   |
| 4 | VOL+ <ul style="list-style-type: none"> <li>• Turn up the volume when the speaker is on.</li> <li>• While in a menu, press to scroll up, or to enter an item's sub-menu.</li> <li>• While zooming in <b>SINGLE-CAM</b> or <b>PATROL</b> mode, press and hold to move the zoomed image upward.</li> </ul> |
|   | VOL- <ul style="list-style-type: none"> <li>• Turn down the volume when the speaker is on.</li> <li>• While in a menu, press to scroll down.</li> <li>• While zooming in <b>SINGLE-CAM</b> or <b>PATROL</b> mode, press and hold to move the zoomed image downward.</li> </ul>                           |

|    |   |
|----|---|
| 5  | MENU/SELECT <ul style="list-style-type: none"> <li>• Press to enter/exit the menu.</li> <li>• While in a sub-menu, press to choose an item, or save a setting.</li> </ul>   |
| 6  | <ul style="list-style-type: none"> <li>• While in a menu, press to choose the next item on the left, or enter into the submenu, if any.</li> <li>• While zooming in <b>SINGLE-CAM</b> and <b>PATROL</b> mode, press and hold to move the zoomed image leftward.</li> <li>• While in a menu, press to choose the next item on the right, or return to the main menu while in submenu.</li> <li>• While zooming in <b>SINGLE-CAM</b> or <b>PATROL</b> mode, press and hold to move the zoomed image rightward.</li> </ul> |
| 7  | On/off <ul style="list-style-type: none"> <li>• Press and hold to power on.</li> <li>• Press and hold again to power off.</li> </ul>  |
| 8  | TALK <ul style="list-style-type: none"> <li>• Press and hold to talk to the selected baby unit in <b>SINGLE-CAM</b> or <b>PATROL</b> mode.</li> </ul>   |
| 9  | PATROL <ul style="list-style-type: none"> <li>• Press to turn on or off the <b>PATROL</b> mode.</li> </ul>  |
| 10 | LCD ON/OFF <ul style="list-style-type: none"> <li>• Press to turn on or off the LCD screen.</li> </ul>  |
| 11 | Speaker   |
| 12 | Power jack  |
| 13 | Battery compartment cover   |
| 14 | Stand   |

### Parent unit lights

|      |  |
|------|--|
|      | On when the parent unit is linked to the baby unit.<br>Flashes quickly when the link to the baby unit is nearly lost. Flashes when the link to at least one of the baby units is lost.                   |
|      | On when the parent unit is connected to AC power, or the battery is charging.<br>Flashes when the parent unit battery is low and needs charging. Off when the parent unit is disconnected from AC power. |
| TALK | On when the parent unit is talking to the baby unit.   |
|      | On when the speaker volume of the parent unit is turned off.   |

### Parent unit status icons

|  |   |
|--|---|
|  | Connection status <ul style="list-style-type: none"> <li>•  or  displays when strong signal strength is detected between the baby unit and the parent unit.</li> <li>•  or  displays when moderate or low signal strength is detected between the baby unit and the parent unit.</li> <li>•  displays when the link between the baby unit and the parent unit is lost.</li> </ul> |
|  | Patrol mode <ul style="list-style-type: none"> <li>• Displays when the parent unit is in <b>PATROL</b> mode.</li> </ul>   |
|  | Current view status <ul style="list-style-type: none"> <li>• Displays the number of the baby unit that is being viewed when in <b>SINGLE-CAM</b> or <b>PATROL</b> mode.</li> </ul>  |
|  | Zoom <ul style="list-style-type: none"> <li>• Displays when the camera at the baby unit has zoomed in.</li> </ul>   |
|  | Night vision <ul style="list-style-type: none"> <li>• Displays when the baby unit being viewed has activated the night vision feature.</li> </ul>   |

|  |   |
|--|---|
|  | Lullaby <ul style="list-style-type: none"> <li>• Displays when a lullaby is playing.</li> </ul>   |
|  | Talkback <ul style="list-style-type: none"> <li>• Displays when talking back to the baby units from parent unit.</li> </ul>   |
|  | 6-level sound indicator <ul style="list-style-type: none"> <li>• Displays the sound level according to the scales of loudness when there is sound transmitted from the baby unit.</li> <li>•  (1 to 2 bars) indicates low sound level detected by the baby unit.</li> <li>•  (3 to 4 bars) indicates moderate sound level detected by the baby unit.</li> <li>•  (5 to 6 bars) indicates high sound level detected by the baby unit (e.g. baby crying loudly).</li> </ul> |
|  | Mute alert <ul style="list-style-type: none"> <li>• Displays when the parent unit speaker volume is set to off.</li> </ul>  |
|  | Real-time temperature <ul style="list-style-type: none"> <li>• Displays the real-time temperature detected by the baby unit in Fahrenheit (°F) or Celsius (°C) (e.g. 57 °F or 14 °C).</li> </ul>  |
|  | Battery status <ul style="list-style-type: none"> <li>•  animates when the battery is charging.</li> <li>•  displays solid when the battery is fully charged.</li> <li>•  displays when the battery is low and needs charging.</li> </ul>   |
|  | AC power without battery <ul style="list-style-type: none"> <li>• Displays when the parent unit is connected to AC power without the battery.</li> </ul>  |
|  | Speaker volume <ul style="list-style-type: none"> <li>• Displays the parent unit speaker volume level while adjusting.</li> </ul>   |

### Parent unit main menu icons

|  |   |
|--|---|
|  | Brightness <ul style="list-style-type: none"> <li>• You can change the brightness of the parent unit screen.</li> </ul>   |
|  | Pairing baby unit <ul style="list-style-type: none"> <li>• The baby unit and parent unit provided are already paired. You can add or replace baby units (VM3211, purchased separately) to your baby monitor system.</li> </ul>                          |
|  | LCD screen off timer <ul style="list-style-type: none"> <li>• You can set a specific time to screen off your parent unit.</li> </ul>  |
|  | Temperature <ul style="list-style-type: none"> <li>• You can turn on the <b>Temperature alert tone</b> so that the parent unit beeps whenever the room temperature detected by the baby unit falls outside of the desired temperature range.</li> </ul> |
|  | Lullaby <ul style="list-style-type: none"> <li>• You can select, play, or stop a lullaby.</li> </ul>  |

### Parent unit warning icons and messages

|  |  |
|--|--|
|  | No link to Camera <ul style="list-style-type: none"> <li>• The selected baby unit is out of range or is turned off.</li> </ul>   |
|  | Battery low at Parent Unit <ul style="list-style-type: none"> <li>• The battery is empty and needs to be recharged.</li> </ul>   |
|  | Pairing is completed.  |
|  | Camera switching, pairing is in progress.  |
|  | Camera switching, pairing is failed.   |
|  | Temperature too high <ul style="list-style-type: none"> <li>• The temperature detected by the baby unit is higher/lower than the desired temperature alert range.</li> </ul> |
|  | Temperature too low <ul style="list-style-type: none"> <li>• The temperature detected by the baby unit is higher/lower than the desired temperature alert range.</li> </ul>  |
|  | The baby unit is unpairing from the parent unit.   |
|  | The parent unit is searching for baby units.   |

\* # represents the selected baby unit number.

### Using the baby monitor

#### Power on or off the baby unit

- Slide the **ON/OFF** switch up to turn on the baby unit. The **ON/OFF** LED light turns on.
- Slide the **ON/OFF** switch down to turn off the baby unit. The **ON/OFF** LED light turns off.

#### Power on or off the parent unit

- Press and hold **ON** to turn on the parent unit. The screen turns on.
- Press and hold **OFF** again to turn off the parent unit. The screen turns off.

#### Turn on or off the parent unit screen

- You can turn on or off the parent unit screen without powering off the parent unit. You can still hear sound from the baby unit.
- Press **LCD ON/OFF** on the parent unit to turn off the screen.
- Press any key on the parent unit to turn on the screen again.

#### Adjust speaker volume

- Press **VOL+/VOL-** on the parent unit to adjust the speaker volume.

#### NOTE

- When the parent unit speaker volume is set to zero, appears on the screen and the light turns on.

#### For baby unit:

- The baby unit speaker volume determines the talkback volume transmitted from your parent unit.
- Press **+/VOLUME-** on the baby unit to adjust the speaker volume.

### Adjust LCD brightness

You can change the brightness of the parent unit screen from **Level 1** to **Level 5**. The LCD brightness is preset to **Level 3**.

1. Press **MENU** when the parent unit is idle.
2. Press or to choose , then press .
3. Press or to choose the desired level of brightness, then press **SELECT** to confirm your selection.

### Monitoring mode

Every time the parent unit is turned on, it displays a baby unit in **SINGLE-CAM** mode. If there are more than one baby units in your system, you can also monitor your baby in **PATROL** mode.

|            |  |
|------------|--|
| SINGLE-CAM | The screen displays image of a single baby unit in full screen.            |
| PATROL     | A single cam view that transits to a different baby unit every 10 seconds. |

#### In SINGLE-CAM mode:

- Press **CAM** to switch to another camera if you are in **SINGLE-CAM** mode.

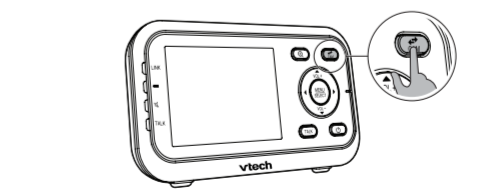

#### In PATROL mode:

- Press **PATROL** to switch to **PATROL** mode if you are in **SINGLE-CAM** mode, and vice versa.

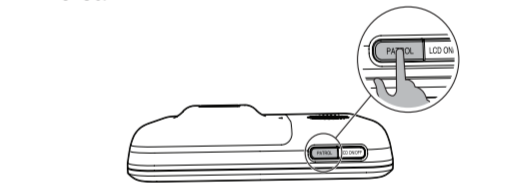

#### Zoom

You can zoom in while viewing images from the baby unit in **SINGLE-CAM** and **PATROL** mode.

- Press to zoom in.
- Press to move the zoomed image upward or downward.
- Press or to move the zoomed image leftward or rightward.
- Press again to zoom out.

#### Talk

You can use the **TALK** function of the parent unit to comfort your baby in **SINGLE-CAM** and **PATROL** mode.



1. Press and hold **TALK** on the parent unit. The **TALK** light turns on.
2. Speak towards the microphone on the parent unit. Your voice is broadcast to the baby unit.
3. Release the **TALK** key to stop the broadcast. The **TALK** light goes off.

## Monitor the temperature

Your baby unit monitors the temperature of your baby's room with its built-in temperature sensor. If the detected temperature is out of the preset temperature range, the parent unit will display an alert message.

### Set temperature range

You can set the desired room temperature alert range. The minimum temperature can be set between **50 °F (10 °C) and 76 °F (24 °C)**. The maximum temperature can be set between **77 °F (25 °C) and 102 °F (39 °C)**.

- Press **MENU** when the parent unit is idle.
- Press **◀** or **▶** to choose , then press **▲**.
- Press **▼** or **▲** to choose , then press **SELECT**.
- Press **▼** or **▲** to choose **Min** or **Max**, then press **SELECT**.
- Press **▼** or **▲** to choose the desired minimum or maximum temperature, then press **SELECT** to confirm your selection.

### Temperature alert tone

You can turn on the temperature alert tone so that the parent unit will emit an alert tone if the detected temperature is out of range.

- Press **MENU** when the parent unit is idle.
- Press **◀** or **▶** to choose , then press **▲**.
- Press **▼** or **▲** to choose **A**, then press **SELECT**.
- Press **▼** or **▲** to choose **On** or **Off**, then press **SELECT** to confirm your selection.



### Temperature format

You can choose to display the temperature in Fahrenheit (°F) or Celsius (°C).

- Press **MENU** when the parent unit is idle.
- Press **◀** or **▶** to choose , then press **▲**.
- Press **▼** or **▲** to choose **F**, then press **SELECT**.
- Press **▼** or **▲** to choose **F** or **°C**, then press **SELECT** to confirm your selection.

## Pair extra new baby unit (VM3211)

You can add or replace any baby units (**VM3211**, purchased separately) to your **VM3251/VM3251-2** Video Monitor with Adjustable Lens. You can pair a maximum of four baby units to your parent unit.

- Press **MENU** when the parent unit is idle.
- Press **◀** or **▶** to choose , then press **▲** to select.
- Press **▼** or **▲** to choose an empty baby unit slot (**1**, **2**, **3**, or **4**), then press **SELECT**. The parent unit screen displays .
- Use a narrow-pointed object, such as a pen, to press **PAIR** on the bottom of the baby unit.
  - The ON/OFF LED light at the side of baby unit flashes quickly when pairing.

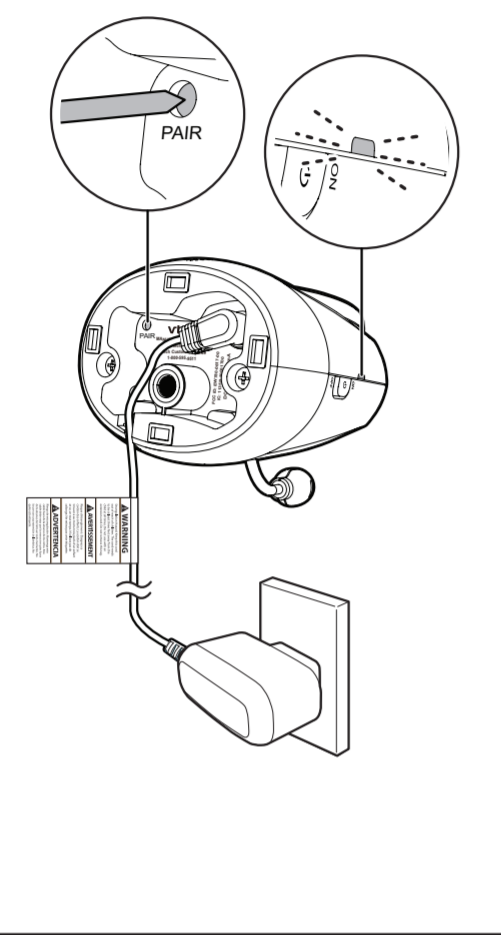

(1) this device may not cause harmful interference, and (2) this device must accept any interference received, including interference that may cause undesired operation.

To ensure safety of users, the FCC has established criteria for the amount of radio frequency energy that can be safely absorbed by a user or bystander according to the intended usage of the product. This product has been tested and found to comply with the FCC criteria. The baby unit shall be installed and used such that parts of all persons' body are maintained at a distance of approximately 8 in (20 cm) or more. The transmitter and antenna of the parent unit shall be held at least 1 in (2.5 cm) from your face.

This Class B digital apparatus complies with Canadian requirement. CAN ICES-3 (B)/NMB-3(B)

### Industry Canada

This device complies with Industry Canada licence-exempt RSS standard(s).

Operation is subject to the following two conditions: (1) this device may not cause harmful interference, and (2) this device must accept any interference, including interference that may cause undesired operation.

The term "IC," before the certification/registration number only signifies that the Industry Canada technical specifications were met.

This product meets the applicable Industry Canada technical specifications.

### RF radiation exposure statement

The baby unit complies with FCC RF radiation exposure limits set forth for an uncontrolled environment. The baby unit should be installed and operated with a minimum distance of 8 in (20 cm) between the baby unit and all persons' body. Use of other accessories may not ensure compliance with FCC RF exposure guidelines. This transmitter must not be co-located or operating in conjunction with any other antenna or transmitter. This equipment complies also with Industry Canada RSS-102 with respect to Canada's Health Code 6 for Exposure of Humans to RF Fields.

## California Energy Commission battery charging testing mode

This baby monitor meets the California Energy Commission (CEC) regulations for energy consumption. Your baby monitor is set up to comply with the energy-conserving standards right out of the box.

Follow the instructions to install and charge the battery. The CEC battery charging testing mode is activated while charging.

Even if the parent unit is paired to baby units, the CEC battery charging testing mode is activated while it is powered off and charging.

When pairing is successful, the parent unit screen displays  and the **LINK** light turns on. The view of the newly paired baby unit in **SINGLE-CAM** mode will be shown on the parent unit. The ON/OFF LED light on the new baby unit remains on.

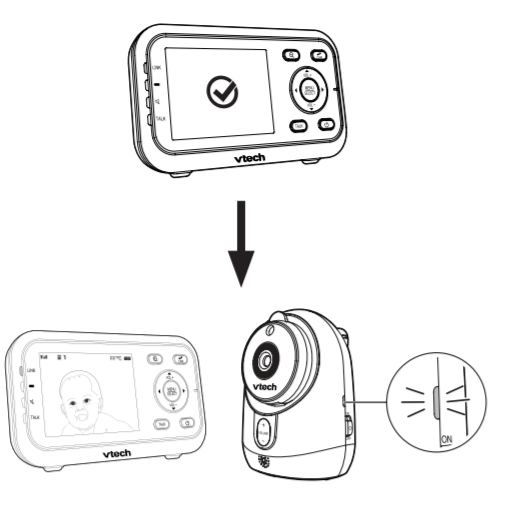

- NOTES**
- If pairing fails, the screen displays . Try the pairing process again.
- Only one baby unit can be paired at a time.

## General product care

To keep this product working well and looking good, follow these guidelines:

- Avoid putting it near heating appliances and devices that generate electrical noise (for example, motors or fluorescent lamps).
- DO NOT expose it to direct sunlight or moisture.
- Avoid dropping the product or treating it roughly.
- Clean with a soft cloth.
- DO NOT immerse the parent unit and the baby unit in water and do not clean them under the tap.
- DO NOT use cleaning spray or liquid cleaners.
- Make sure the baby unit and parent unit are dry before you connect them to the mains again.

## Storage

When you are not going to use the baby monitor for some time, remove the rechargeable battery from the parent unit. Store the parent unit, the baby unit and the adapters in a cool and dry place.

## Frequently asked questions

Below are the questions most frequently asked about the baby monitor. If you cannot find the answer to your question, visit our website at **www.vtechphones.com**, or contact **1 (800) 595-9511** for customer service.

|   |  |
|---|--|
| <b>Why does the baby monitor not respond normally?</b>                                  | Try the following (in the order listed) for common cure: <ol style="list-style-type: none"><li>Disconnect the power to the baby units and the parent unit.</li><li>Remove the batteries in the parent unit. Then install the batteries again.</li><li>Wait a few seconds before connecting power back to the baby units and the parent unit.</li><li>Turn on the baby units and the parent unit.</li><li>Wait for the parent unit to synchronize with the baby units. Allow up to one minute for this to take place.</li></ol> |
| <b>Why does the parent unit charge while connected to AC power?</b>                     | You may have used the battery for a long time. Replace a new battery.  |
| <b>Why is my screen in black and white?</b>   | The screen is in black and white during night-time or in a dark room when the night vision feature is activated. This is normal due to external light sources.   |
| <b>Why do I get glare or blurry display on my screen when viewing my baby at night?</b> | During night-time or in a dark room, the surroundings and other light sources, like lightings, objects, colors and backgrounds may affect the image quality on your parent unit screen. Adjust the baby unit's angle or place the baby unit at a higher level to prevent glare and blurry display.   |
| <b>Why does the baby monitor produce a high-pitched noise?</b>                          | The parent unit and baby units may be too close to each other. <ul style="list-style-type: none"><li>Move the parent unit away from the baby units until the noise stops.</li><li>Turn down the volume of your parent unit.</li></ul>  |
| <b>Why does the parent unit beep?</b>   | The baby units may be out of range. Move the parent unit closer to the baby units (but not less than 3 feet). <p>If the parent unit is powered by the provided battery, it may not have enough charge for the parent unit to perform normally. Charge the battery in the parent unit for up to 11 hours.</p> <p>The temperature of your baby's room may be too high or too low.</p>  |

|  |  |
|--|--|
| <b>Why don't the power-on light of the baby unit and parent unit go on when I switch on the units?</b> | Perhaps the parent unit is not connected to the power. Insert the appliance plug into the parent unit and put the adapter in a wall socket. Then press and hold <b>◯</b> to switch on the parent unit and to establish connection with the baby unit. <p>Perhaps the baby unit is not connected to the power. Insert the appliance plug into the baby unit and put the adapter in a wall socket. Then slide the <b>ON/OFF</b> switch to <b>ON</b> to switch on the baby unit and to establish connection with the parent unit.</p> |
| <b>Why doesn't my parent unit charge while connected to AC power?</b>                                  | Make sure the power is not controlled by a wall switch. <p>Make sure the battery is installed.</p>   |

I have accidentally unpaired my baby unit.

When pairing is successful, the parent unit screen displays  and the **LINK** light turns on. The view of the newly paired baby unit in **SINGLE-CAM** mode will be shown on the parent unit. The ON/OFF LED light on the new baby unit remains on.

If pairing fails, the screen displays . Try the pairing process again.

• Only one baby unit can be paired at a time.



The parent unit speaker volume may be too low or off. Press **VOL+** to increase the volume.

Why can't I establish a connection? Why are there sound interruptions?

The baby units may be out of range. Move the parent unit closer to the baby units (but not less than 3 feet).

If the parent unit is powered by the provided battery, it may not have enough charge for the parent unit to perform normally. Charge the battery in the parent unit for up to 11 hours.

The temperature of your baby's room may be too high or too low.

|  |  |
|--|--|
| <b>The ON/OFF light on the baby unit flashes and the parent unit displays .</b> | Follow below steps to pair the baby unit. Make sure both parent unit and baby unit are on before pairing. <ol style="list-style-type: none"><li>Press <b>MENU</b> when the parent unit is idle.</li><li>Press <b>◀</b> or <b>▶</b> to choose , then press <b>▲</b> to select.</li><li>Press <b>▼</b> or <b>▲</b> to choose an empty baby unit slot (1, 2, 3, or 4), then press <b>SELECT</b>. The parent unit screen displays .</li><li>Use a narrow-pointed object, such as a pen, to press <b>PAIR</b> on the bottom of the baby unit. <ul style="list-style-type: none"><li>The ON/OFF LED light at the side of baby unit flashes quickly when pairing.</li></ul></li></ol> |
|--|--|

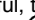
When pairing is successful, the parent unit screen displays  and the **LINK** light turns on. The view of the newly paired baby unit in **SINGLE-CAM** mode will be shown on the parent unit. The ON/OFF LED light on the new baby unit remains on.

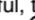
If pairing fails, the screen displays . Try the pairing process again.

- Only one baby unit can be paired at a time.

The parent unit speaker volume may be too low or off. Press **VOL+** to increase the volume.

Why can't I establish a connection? Why are there sound interruptions?

The baby units may be out of range. Move the parent unit closer to the baby units (but not less than 3 feet).

Other electronic products may cause interference with your baby monitor. Try installing your baby monitor as far away from these electronic devices as possible.

## Important safety instructions

When using your equipment, basic safety precautions should always be followed to reduce the risk of fire, electric shock and injury, including the following:

- Follow all warnings and instructions marked on the product.
- Adult setup is required.
- This product is intended as an aid. It is not a substitute for responsible and proper adult supervision and should not be used as such.
- This product is not intended for use as a medical monitor.
- Do not use this product near water. For example, do not use it next to a bath tub, wash bowl, kitchen sink, laundry tub or swimming pool, or in a wet basement or shower.
- CAUTION:** Use only the batteries indicated in this manual. There may be a risk of explosion if a wrong type of battery is used for the parent unit. Use only the supplied rechargeable battery or replacement battery pack (BT198555/ BT298555) for the parent unit. Do not dispose of batteries in a fire. They may explode. Dispose of used battery according to the information in The RBRC® seal.
- Use only the adapters included with this product. Incorrect adapter polarity or voltage can seriously damage the product. Baby unit power adapter: Output: 6V DC 500mA Parent unit power adapter: Output: 6V DC 500mA.
- The power adapters are intended to be correctly oriented in a vertical or floor mount position. The prongs are not designed to hold the plug in place if it is plugged into a ceiling, under-the-table or cabinet outlet.
- For pluggable equipment, the socket-outlet shall be installed near the equipment and shall be easily accessible.
- Unplug this product from the wall outlet before cleaning. Do not use liquid or aerosol cleaners. Use a damp cloth for cleaning.
- Unplug the power cords before replacing batteries.
- Do not cut off the power adapters to replace them with other plugs, as this causes a hazardous situation.
- Do not allow anything to rest on the power cords. Do not install this product where the cords may be walked on or crimped.
- This product should be operated only from the type of power source indicated on the marking label. If you are not sure of the type of power supply in your home, consult your dealer or local power company.
- Do not overload wall outlets or use an extension cord.
- Do not place this product on an unstable table, shelf, stand or other unstable surfaces.
- This product should not be placed in any area where proper ventilation is not provided. Slots and openings in the back or bottom of this

product are provided for ventilation. To protect them from overheating, these openings must not be blocked by placing the product on a soft surface such as a bed, sofa or rug. This product should never be placed near or over a radiator or heat register.

- Never push objects of any kind into this product through the slots because they may touch dangerous voltage points or create a short circuit. Never spill liquid of any kind on the product.
- To reduce the risk of electric shock, do not disassemble this product, but take it to an authorized service facility. Opening or removing parts of the product other than specified access doors may expose you to dangerous voltages or other risks. Incorrect reassembling can cause electric shock when the product is subsequently used.
- You should test the sound reception every time you turn on the units or move one of the components.
- Periodically examine all components for damage.
- Be aware of possible loss of privacy while using public airwaves. Conversations may be picked up by other nursery monitors, cordless phones, scanners, etc.
- Children should be supervised to ensure that they do not play with the product.
- The product is not intended for use by persons (including children) with reduced physical, sensory or mental capabilities, or lack of experience and knowledge, unless they have been given supervision or instruction concerning use of the appliance by a person responsible for their safety.

## SAVE THESE INSTRUCTIONS

## Cautions

- Use and store the product at a temperature between 32°F and 104°F.
- Do not expose the product to extreme cold, heat or direct sunlight. Do not put the product close to a heating source.
- Batteries should not be exposed to excessive heat such as bright sunshine or fire.
- Warning—Strangulation Hazard—Children have STRANGLED in cords.** Keep this cord out of the reach of children (more than 3 ft (0.9 m) away). Do not remove this tag.

- Never place the baby unit(s) inside the baby's crib or playpen. Never cover the baby unit(s) or parent unit with anything such as a towel or a blanket.
- Other electronic products may cause interference with your baby monitor. Try installing your baby monitor as far away from these electronic devices as possible: wireless routers, radios, cellular telephones, intercoms, room monitors, televisions, personal computers, kitchen appliances and cordless telephones.

## Precautions for users of implanted cardiac pacemakers

Cardiac pacemakers (applies only to digital cordless devices):

Wireless Technology Research, LLC (WTR), an independent research entity, led a multidisciplinary evaluation of the interference between portable wireless devices and implanted cardiac pacemakers. Supported by the U.S. Food and Drug Administration, WTR recommends to physicians that:

### Pacemaker patients

- Should keep wireless devices at least six inches from the pacemaker.
- Should **NOT** place wireless devices directly over the pacemaker, such as in a breast pocket, when it is turned ON.

WTR's evaluation did not identify any risk to bystanders with pacemakers from other persons using wireless devices.

### Electromagnetic fields (EMF)

This VTech product complies with all standards regarding electromagnetic fields (EMF). If handled properly and according to the instructions in this user's manual, the product is safe to be used based on scientific evidence available today.

- Reorient or relocate the receiving antenna.
- Increase the separation between the equipment and receiver.
- Connect the equipment into an outlet on a circuit different from that to which the receiver is connected.
- Consult the dealer or an experienced radio/TV technician for help.

**WARNING:** Changes or modifications to this equipment not expressly approved by the party responsible for compliance could void the user's authority to operate the equipment.

This device complies with Part 15 of the FCC rules. Operation is subject to the following two conditions:

## The RBRC® seal

The RBRC® seal on the Ni-MH battery indicates that VTech Communications, Inc. is voluntarily participating in an industry program to collect and recycle these batteries at the end of their useful lives, when taken out of service within the United States and Canada.

The RBRC® program provides a convenient alternative to placing used Ni-MH batteries into the trash or municipal waste, which may be illegal in your area.

VTech's participation in RBRC® makes it easy for you to drop off the spent battery at local retailers participating in the RBRC® program or at authorized VTech product service centers. Please call **1 (800) 8 BATTERY™** for information on Ni-MH battery recycling and disposal bans/restrictions in your area. VTech's involvement in this program and part of its commitment to protecting our environment and conserving natural resources.



RBRC® and 1 (800) 8 BATTERY™ are registered trademarks of the Rechargeable Battery Recycling Corporation.

## FCC and IC regulations

### FCC Part 15

This equipment has been tested and found to comply with the requirements for a Class B digital device under Part 15 of the Federal Communications Commission (FCC) rules. These requirements are intended to provide reasonable protection against harmful interference in a residential installation. This equipment generates, uses and can radiate radio frequency energy and, if not installed and used in accordance with the instructions, may cause harmful interference to radio communications. However, there is no guarantee that interference will not occur in a particular installation. If this equipment does cause harmful interference to radio or television reception, which can be determined by turning the equipment off and on, the user is encouraged to try to correct the interference by one or more of the following measures:

- Reorient or relocate the receiving antenna.
  - Increase the separation between the equipment and receiver.
  - Connect the equipment into an outlet on a circuit different from that to which the receiver is connected.
  - Consult the dealer or an experienced radio/TV technician for help.
- WARNING:** Changes or modifications to this equipment not expressly approved by the party responsible for compliance could void the user's authority to operate the equipment.
- This device complies with Part 15 of the FCC rules. Operation is subject to the following two conditions:

## Technical specifications

|                         |   |
|-------------------------|---|
| Frequency control       | Crystal controlled PLL synthesizer  |
| Transmit frequency      | Baby unit: 2405 - 2475 MHz Parent unit: 2405 - 2475 MHz   |
| Channels                | 32  |
| LCD                     | 2.8" Color LCD (WQVGA 320x240 pixel)  |
| Nominal effective range | Maximum power allowed by FCC and IC. Actual operating range may vary according to environmental conditions at the time of use.  |
| Power requirements      | Parent unit: 3.6V Ni-MH battery Baby unit power adapter: Output: 6V DC @ 500mA Parent unit power adapter: Output: 6V DC @ 500mA |

serial number plates or electronic serial numbers have been removed, altered or rendered illegible; or

- Product purchased, used, serviced, or shipped for repair from outside the United States of America or Canada, or used for commercial or institutional purposes (including but not limited to Products used for rental purposes); or
- Product returned without a valid proof of purchase (see item 2 on the next page); or
- Charges for installation or set up, adjustment of customer controls, and installation or repair of systems outside the unit.

### How do you get warranty service?

To obtain warranty service in the USA, please visit our website at [www.vtechphones.com](http://www.vtechphones.com) or call 1 (800) 595-9511. In Canada, go to [www.vtechcanada.com](http://www.vtechcanada.com) or call 1 (800) 267-7377.

NOTE: Before calling for service, please review the user's manual - a check of the Product's controls and features may save you a service call.

Except as provided by applicable law, you assume the risk of loss or damage during transit and transportation and are responsible for delivery or handling charges incurred in the transport of the Product(s) to the service location. VTech will return repaired or replaced Product under this limited warranty. Transportation, delivery or handling charges are prepaid. VTech assumes no risk for damage or loss of the Product in transit. If the Product failure is not covered by this limited warranty, or proof of purchase does not meet the terms of this limited warranty, VTech will notify you and will request that you authorize the cost of repair prior to any further repair activity. You must pay for the cost of repair and return shipping costs for the repair of Products that are not covered by this limited warranty.

### What must you return with the Product to get warranty service?

- Return the entire original package and contents including the Product to the VTech service location along with a description of the malfunction or difficulty; and
- Include a "valid proof of purchase" (sales receipt) identifying the Product purchased (Product model) and the date of purchase or receipt; and
- Provide your name, complete and correct mailing address, and telephone number.

### Other limitations

This warranty is the complete and exclusive agreement between you and VTech. It supersedes all other written or oral communications related to this Product. VTech provides no other warranties for this Product. The warranty exclusively describes all of VTech's responsibilities regarding the Product. There are no other express warranties. No one is authorized to make modifications to this limited warranty and you should not rely on any such modification.

## Limited warranty

### What does this limited warranty cover?

The manufacturer of this VTech Product warrants to the holder of a valid proof of purchase ("Consumer" or "you") that the Product and all accessories provided in the sales package ("Product") are free from defects in material and workmanship, pursuant to the following terms and conditions, when installed and used normally and in accordance with the Product operating instructions. This limited warranty extends only to the Consumer for Products purchased and used in the United States of America and Canada.

**What will VTech do if the Product is not free from defects in materials and workmanship during the limited warranty period ("Materially Defective Product")?**

During the limited warranty period, VTech's authorized service representative will repair or replace at VTech's option, without charge, a Materially Defective Product. If we repair the Product, we may use new or refurbished replacement parts. If we choose to replace the Product, we may replace it with a new or refurbished Product of the same or similar design. We will retain defective parts, modules, or equipment. Repair or replacement of the Product, at VTech's option, is your exclusive remedy. VTech will return the repaired or replacement Products to you in working condition. You should expect the repair or replacement to take approximately 30 days.

### How long is the limited warranty period?

The limited warranty period for the Product extends for ONE (1) YEAR from the date of purchase. If VTech repairs or replaces a Materially Defective Product under the terms of this limited warranty, this limited warranty also applies to the repaired or replacement Product for a period of either (a) 90 days from the date the repaired or replacement Product is shipped to you or (b) the time remaining on the original one-year warranty; whichever is longer.

### What is not covered by this limited warranty?

This limited warranty does not cover:

- Product that has been subjected to misuse, accident, shipping or other physical damage, improper installation, abnormal operation or handling, neglect, inundation, fire, water or other liquid intrusion; or
- Product that has been damaged due to repair, alteration or modification by anyone other than an authorized service representative of VTech; or
- Product to the extent that the problem experienced is caused by signal conditions, network reliability, or cable or antenna systems; or
- Product to the extent that the problem is caused by use with non-VTech accessories; or
- Product whose warranty/quality stickers, product

## For C-UL compliance only

### Mesures de sécurité importantes

Lorsque vous utilisez votre appareil, vous devriez toujours suivre certaines mesures de précaution de base afin de réduire les risques d'incendie, d'électrocution et de blessures corporelles, dont ceux qui suivent :

- Observez toutes les instructions et mises en garde inscrites sur l'appareil.
- L'installation par un adulte est requise.
- Ce produit a été conçu pour tre un dispositif d'appoint seulement. Il n'est pas le remplacement d'une supervision responsable et adéquate par un adulte et ne devrait pas tre utilisé comme telle.
- Ce produit n'est pas conçu pour tre utilisé en tant que moniteur médical.
- N'utilisez pas cet appareil pr s de l'eau ni de toute autre source d'humidité, par exemple, pr s d'une baignoire, cuve lessive, évier de cuisine, dans un sous-sol humide ni pr s d'une piscine, dans un sous-sol humide ou une douche.
- MISE EN GARDE:** Il peut y avoir un risque d'explosion si vous utilisez le mauvais type de piles pour l'unité du parent. N'utilisez que le bloc-piles rechargeable inclus ou le bloc-piles de rechange (BT198555/BT298555). N'incinerez pas les piles. Celles-ci risqueraient d'exploser. Jetez les piles usées selon les renseignements suivant le sceau du RBRC®.
- N'utilisez que les adaptateurs inclus avec ce produit. L'utilisation d'un adaptateur dont la polarité ou la tension serait inadéquate risque d'endommager sérieusement le produit et mettre votre sécurité en péril. Adaptateur de l'unité du bébé : Sortie : 5V CC 1000mA Adaptateur de l'unité du parent : Sortie : 5V CC 1000mA
- Lorsqu'ils sont branchés dans une prise de courant, les adaptateurs secteur ont été conçus pour tre orientés correctement, soit la verticale ou au plancher. Les broches n'ont pas été conçues pour supporter le poids du bloc d'alimentation et le maintenir en place si celui-ci est branché dans une prise au plafond, sous une table ou dans un meuble.
- Pour les PRODUITS BRANCHER UNE PRISE DE COURANT, la prise de courant doit tre installée pr s du produit, afin d'assurer une accessibilité sécuritaire la prise de courant.
- Débranchez ce produit de la prise de courant avant de procéder au nettoyage. N'utilisez pas de nettoyants en aérosols. Utilisez un chiffon humide pour le nettoyage.
- Débranchez les cordons d'alimentation avant de remplacer le bloc-piles.
- Ne coupez pas les cordons d'alimentation pour remplacer les fiches, car ceci peut présenter un danger potentiel.

### CONSERVER CES INSTRUCTIONS



Specifications are subject to change without notice. © 2017 VTech Communications, Inc. All rights reserved. 04/17\_VM3251-X\_CIB\_V Document order numbers: 91-010414-050-100